



GREWE, INC.
COMMERCIAL REAL ESTATE

Manchester Commons Manchester, MO

RETAIL SPACE

| | | |
|-----|-----------------------------|-------------|
| 1. | LA-Z-BOY FURNITURE GALLERY | 19,898 S.F. |
| 2A. | KITCHEN & GRANITE CREATIONS | 1,983 S.F. |
| 2B. | ONE STOP LIQUOR | 2,450 S.F. |
| 3. | AVAILABLE | 4,550 S.F. |
| 3A. | JIMMY JOHN'S | 1,400 S.F. |
| 4. | PALM BEACH TAN | 2,512 S.F. |
| 5. | SPA CENTRAL | 1,688 S.F. |
| 6. | SPORTS CLIPS | 1,400 S.F. |
| 7. | U BREAK I FIX | 1,050 S.F. |
| 8. | STATE FARM | 945 S.F. |
| 9. | SAGA RUGS | 2,695 S.F. |
| 10. | FRO YO | 1,400 S.F. |
| 11. | AVAILABLE 11/1/2018 | 4,200 S.F. |
| 12. | T-MOBILE | 2,100 S.F. |
| 13. | QDOBA | 2,712 S.F. |

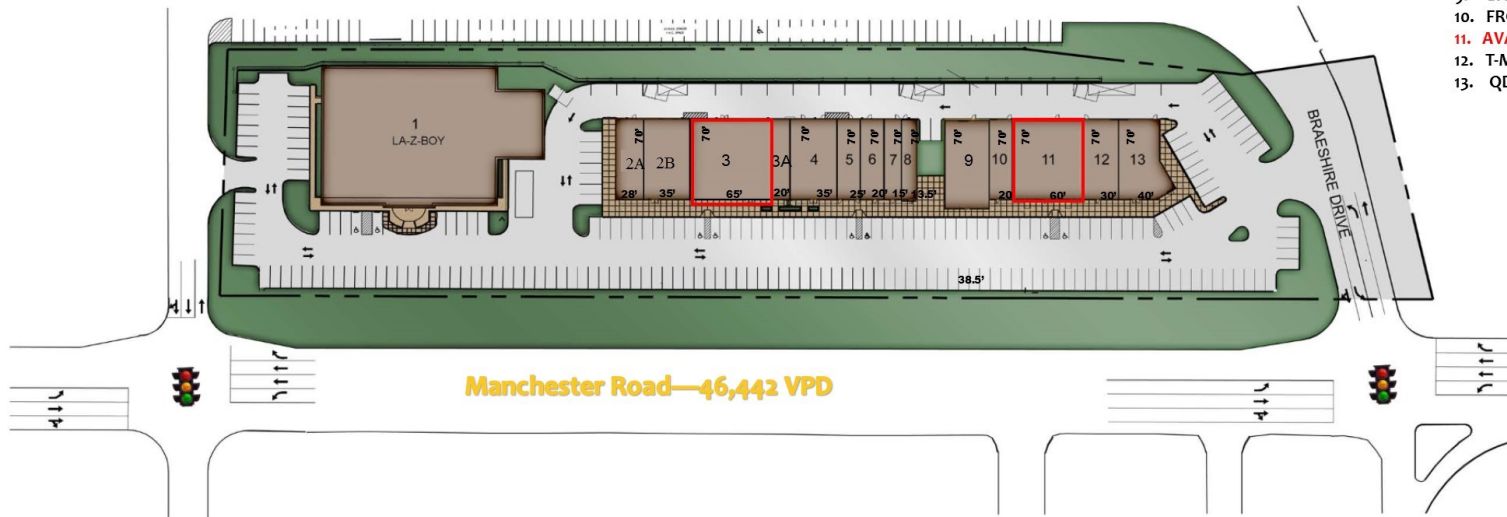

FOR INFORMATION CONTACT:



Architects of the Possible®
8251 Maryland Suite 300
St. Louis, Missouri 63105

MANCHESTER COMMONS
ST. LOUIS COUNTY, MISSOURI

GOOD NEWS FOR PEOPLE ON THE GROW.
G.J. Grewe, Inc. 9109 Watson Rd., 4th Floor, St. Louis, MO 63126
www.gjgrewe.com