



GRAVOIS PLAZA

St. Louis, Missouri

129,000 SF



Contact Information:
 Kyle Lenzen
 314.600.2351
 klenzen@gjgrewe.com

GRAVOIS PLAZA

Here is your opportunity to join a great lineup of National Tenants. The Gravois Plaza Shopping Center, located on Gravois Road in South St. Louis city, is 0.4 miles east of Chippewa Street and 0.3 miles west of Grand Boulevard. Gravois Plaza provides access to a very dense customer base of approximately 158,000 people in a 3 mile radius. A signalized entrance allows easy access for the 17,000 vehicles per day that travel on Gravois Avenue in front of the development. Several small shop opportunities are available.

- Current tenants include:



Intersection of Gravois Ave. & Bamberger Ave. St. Louis, MO

[DEMOGRAPHICS]

1-Mile Radius | 3-Mile Radius | 5-Mile Radius

Med. Household Income	\$37,263	\$44,649	\$44,856
Total Population	30,177	158,357	329,777
Daytime Employment	76,804	86,498	269,575

[AVERAGE DAILY TRAFFIC]

Gravois Ave. 17,000

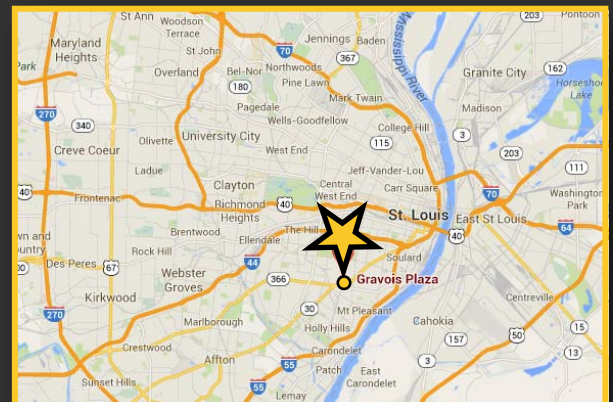

GOOD NEWS FOR PEOPLE ON THE GROW.

G.J. Grewe Brokerage & Development LLC 9109 Watson Rd., 4th Floor, St. Louis, MO 63126

www.gjgrewe.com

GRAVOIS PLAZA

St. Louis, Missouri
129,000 SF

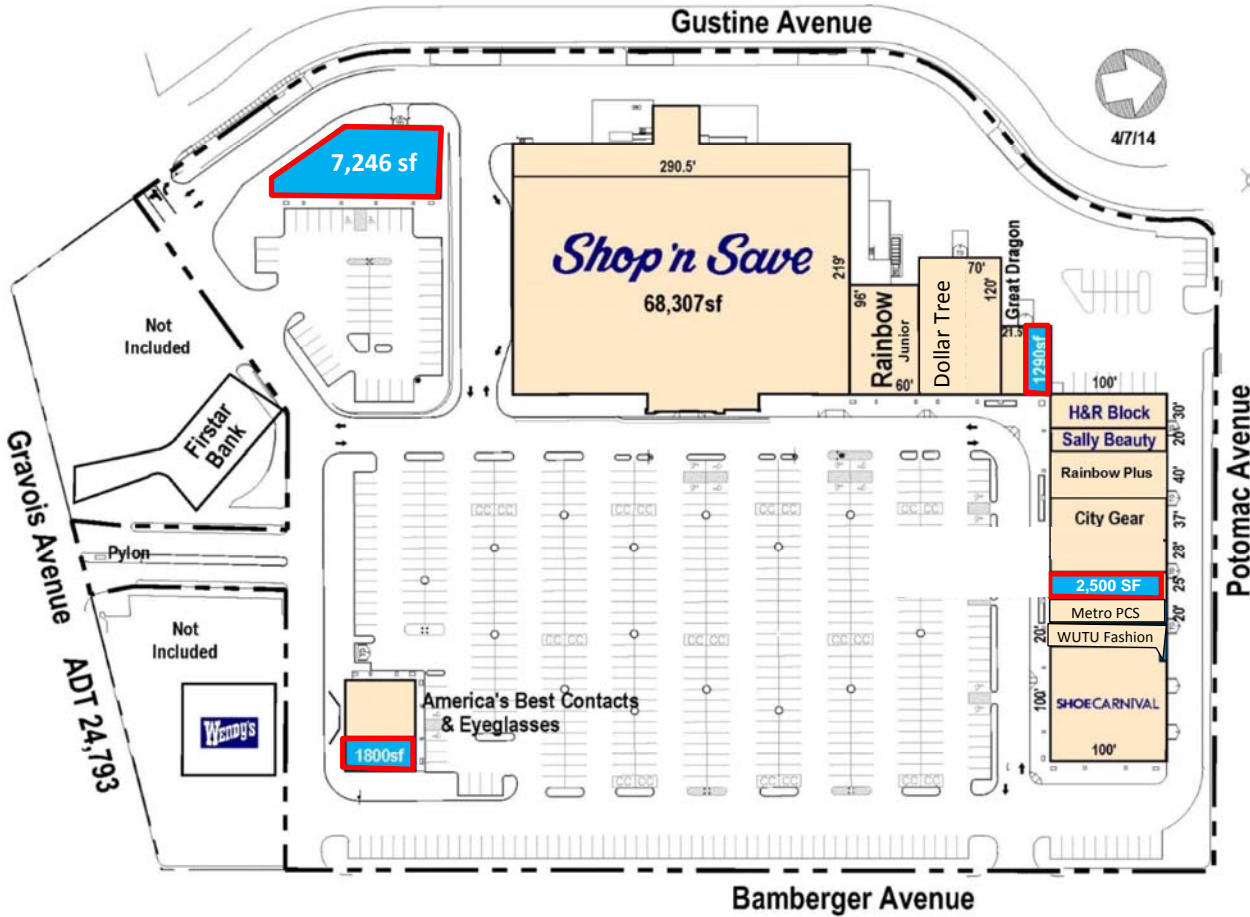

AVAILABLE	7,246 SF
America's Best	3,000 SF
AVAILABLE	1,800 SF
Shop 'N Save	68,307 SF
Rainbow Junior	5,760 SF
Dollar Tree	8,400 SF
Great Dragon	1,290 SF
AVAILABLE	1,290 SF
H&R Block	3,000 SF
Sally Beauty	2,000 SF
Rainbow Plus	4,000 SF
City Gear	6,500 SF
AVAILABLE	2,500 SF
Metro PCS	2,000 SF
WUTU Fashion	2,072 SF
Shoe Carnival	10,000 SF

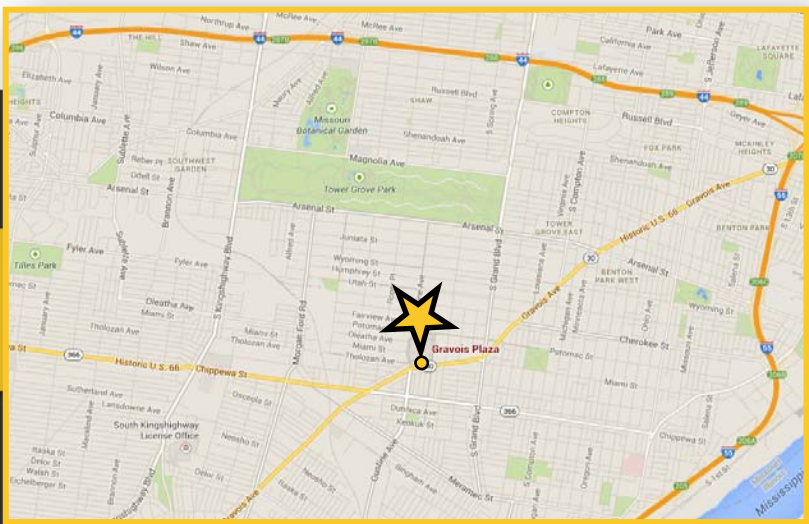

Contact Information:
Kyle Lenzen
314.600.2351
klenzen@gjgrewe.com

GOOD NEWS FOR PEOPLE ON THE GROW.

G.J. Grewe Brokerage & Development LLC 9109 Watson Rd., 4th Floor, St. Louis, MO 63126

www.gjgrewe.com