

CRESTWOOD SQUARE

Crestwood, Missouri



Contact Information:
Gary Grewe
 314.962.6300
 gary@gjgrewe.com

CRESTWOOD SQUARE

Crestwood is a mature suburban community in the desirable southwestern portion of St. Louis County, Missouri—the heart of the St. Louis metropolitan region. Located just east of the interchange of Interstates 270 and 44, the city is easily reached from all directions. Watson Road has been a proven thoroughfare for national and regional tenants for many years.

● **Current tenants include:**



Intersection of Watson Rd. & Pardee Lane Crestwood, MO

[DEMOGRAPHICS]

	1-Mile Radius	3-Mile Radius	5-Mile Radius
Med. Household Income	\$85,180	\$89,409	\$84,517
Total Population	10,654	92,296	228,426
Daytime Employment	3,418	52,500	141,161

[AVERAGE DAILY TRAFFIC]

Watson Rd.	17,745 VPD
------------	------------



GOOD NEWS FOR PEOPLE ON THE GROW.



CRESTWOOD SQUARE

Crestwood, Missouri

RETAIL SPACE

- 1. WESTLAKE ACE HARDWARE 27,916 S.F.
- 2. MONKEY JOE'S 12,778 S.F.
- 3. ST. LOUIS COUNTY OFFICE 14,920 S.F.
- 4. FRIAR TUCK 18,888 S.F.
- 5. PRIMARY EYECARE & EYEWARE 1,840 S.F.
- 6. UPS STORE 1,586 S.F.
- 7. AVAILABLE 3,092 S.F.

OUTLOT A

APPLEBEES

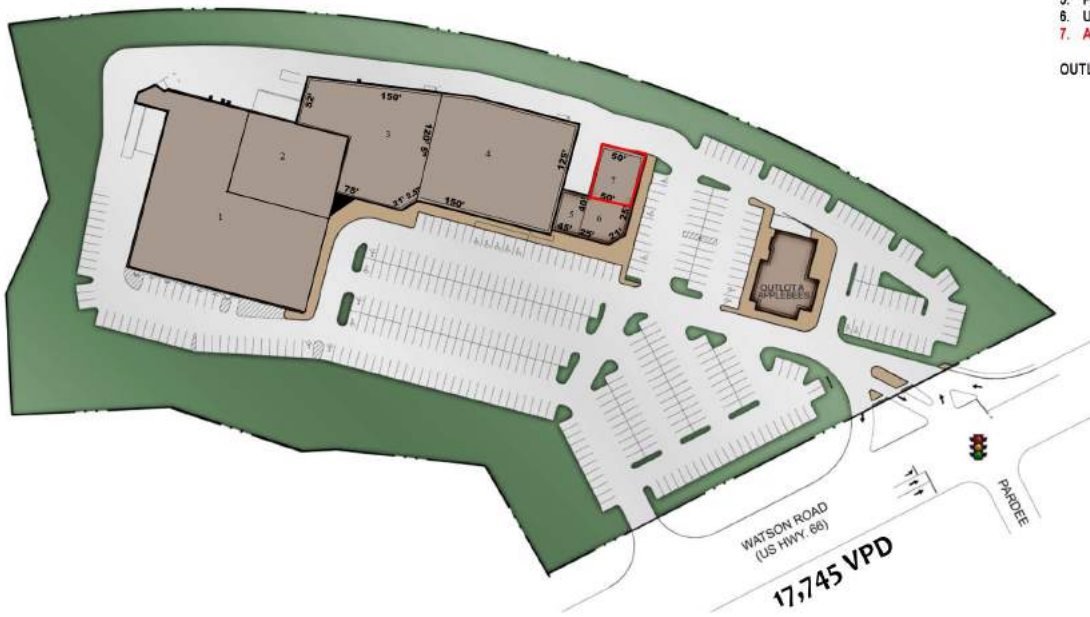

CRESTWOOD SQUARE
CRESTWOOD, MISSOURI

FOR INFORMATION CONTACT:
G GREWE, INC.
9109 WATSON ROAD
4TH FLOOR
ST. LOUIS, MO 63126
314-962-6300 fax: 314-962-7877



Contact Information:
Gary Grewe
314.962.6300
gary@gjgrewe.com

GOOD NEWS FOR PEOPLE ON THE GROW.

G.J. Grewe Brokerage & Development LLC 9109 Watson Rd., 4th Floor, St. Louis, MO 63126

www.gjgrewe.com