

WATSON PLAZA

Crestwood, Missouri



Contact Information:
Gary Grewe
 314.962.6300
 gary@gjgrewe.com

WATSON PLAZA

Watson Plaza is located in Crestwood just two miles east of the Highway 270 and Highway 44 interchange. This Shop 'n Save anchored and Kohl's shadow anchored shopping center has strong radius pull and generates substantial walk-by traffic. This Plaza's excellent location provides a convenient and high-traffic shopping destination for the surrounding residents of Sunset Hills, Kirkwood, Webster Groves, Shrewsbury and Sappington.

- **Current tenants include:**



Intersection of Watson Rd. & Sappington Rd. Crestwood, MO

[DEMOGRAPHICS]

	1-Mile Radius	3-Mile Radius	5-Mile Radius
Med. Household Income	\$71,904	\$82,439	\$78,855
Total Population	10,590	78,162	194,879
Daytime Employment	8,591	41,698	141,963

[AVERAGE DAILY TRAFFIC]

Watson Rd.	17,745 VPD
Sappington Rd.	13,000 VPD



GOOD NEWS FOR PEOPLE ON THE GROW.

G.J. Grewe Brokerage & Development LLC 9109 Watson Rd., 4th Floor, St. Louis, MO 63126

www.gjgrewe.com

WATSON PLAZA

Crestwood, Missouri

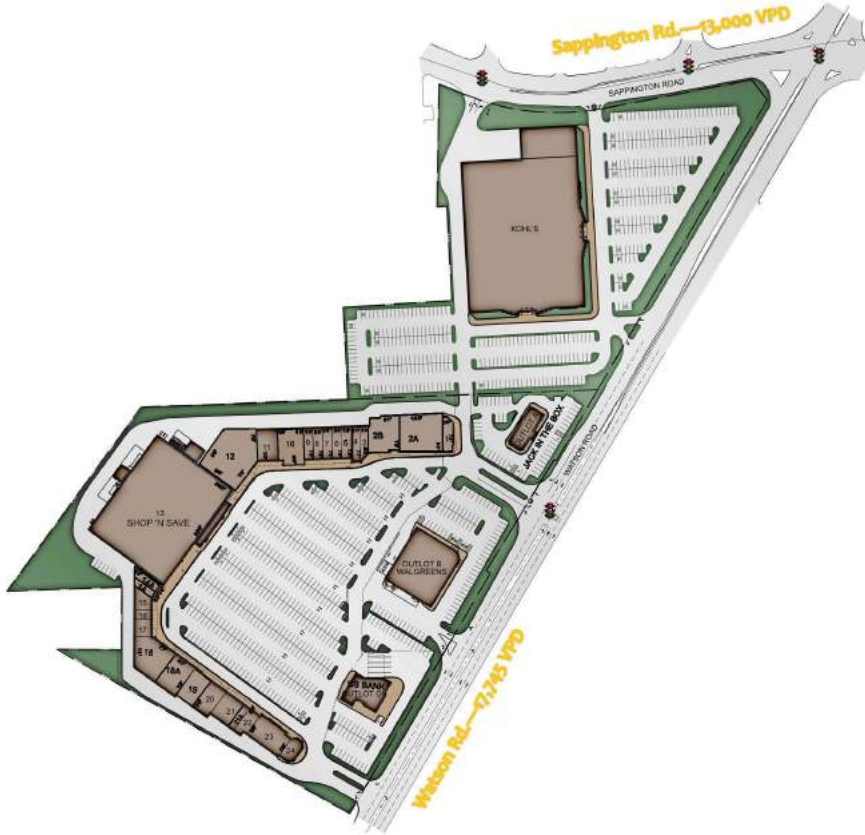

RETAIL SPACE

- | | |
|-------------------------------------|-------------|
| 1. LOOK AFTER HAIR CO | 1,510 S.F. |
| 2A. SPORTS MED & TRAINING CTR. | 8,280 S.F. |
| 2B. CATHERINE'S PLUS SIZES | 4,000 S.F. |
| 3. CHINA KING | 1,400 S.F. |
| 4. GATEWAY CLEANERS | 1,650 S.F. |
| 5. SPECTRUM EYEGLASS REPAIR | 1,250 S.F. |
| 6. GNC | 1,400 S.F. |
| 7. EDWARD JONES | 1,400 S.F. |
| 8. SOUND STONE MASSAGE | 1,700 S.F. |
| 9. A TOUCH OF ITALY | 1,102 S.F. |
| 10. HALLMARK | 4,015 S.F. |
| 11. AMERICA'S CONTACTS & EYEGLASSES | 3,360 S.F. |
| 12. TUESDAY MORNING | 10,480 S.F. |
| 13. SHOP 'N SAVE | 53,774 S.F. |
| 14A. PRETTY PAWS DOG GROOMING | 1,550 S.F. |
| 14. STATE FARM | 1,200 S.F. |
| 15. CHIROPRACTOR | 1,100 S.F. |
| 16. CPR | 800 S.F. |
| 17. ROSE NAIL | 1,565 S.F. |
| 18. ANYTIME FITNESS | 6,600 S.F. |
| 18A. YETI GAMING | 3,915 S.F. |
| 19. THE PISA GROUP | 2,485 S.F. |
| 20. ONE MAIN FINANCIAL | 2,552 S.F. |
| 21. FREDERICK'S BEAUTY ETC. | 2,400 S.F. |
| 21A. LITTLE CAESARS PIZZA | 1,200 S.F. |
| 22. SOUTHWESTERN HEARING AID | 1,700 S.F. |
| 23. EL AGAVE | 4,000 S.F. |
| 24. AQUEOUS VAPOR | 2,000 S.F. |

- | | |
|----------|-----------------|
| OUTLOT A | JACK-IN-THE-BOX |
| OUTLOT B | WALGREENS |
| OUTLOT C | US BANK |



LOCATION MAP
NOT TO SCALE

FOR INFORMATION CONTACT:

TRI
Architects of the Possible
825 Maryland Suite 303
St. Louis, Missouri 63103
© Copyright 2008

WATSON PLAZA
CRESTWOOD, MISSOURI



Contact Information:
Gary Grewe
314.962.6300
gary@gjgrewe.com

GOOD NEWS FOR PEOPLE ON THE GROW.

G.J. Grewe Brokerage & Development LLC 9109 Watson Rd., 4th Floor, St. Louis, MO 63126

www.gjgrewe.com