



GREWE

BROKERAGE &
DEVELOPMENT, LLC

[MID RIVERS PLAZA]

St. Peters, Missouri



Contact Information:
Gary Grewe
314.962.6300
gary@gjgrewe.com

MID RIVERS PLAZA

Mid Rivers Plaza is a fantastic center for regional and national tenants alike. Located across from Mid Rivers Mall, the tenants in the shopping center cannot be found anywhere else in the St. Charles area, making it a desirable location for large and small tenants. Mid Rivers Plaza is visible by over 145,000 vehicles a day from I-70 and several tenants within the center have expanded their size.

- Current tenants include:



Intersection of I-70 & Mid Rivers Mall Dr. St. Peters, MO

[DEMOGRAPHICS]

1-Mile Radius | 3-Mile Radius | 5-Mile Radius

| | | | |
|-----------------------|----------|----------|----------|
| Med. Household Income | \$56,268 | \$76,975 | \$77,579 |
| Total Population | 9,043 | 56,208 | 151,677 |
| Daytime Employment | 11,671 | 23,898 | 55,958 |

[AVERAGE DAILY TRAFFIC]

| | |
|---------------------|-------------|
| Interstate 70 | 145,748 VPD |
| Mid Rivers Mall Dr. | 33,557 VPD |



GOOD NEWS FOR PEOPLE ON THE GROW.

G.J. Grewe Brokerage & Development LLC 9109 Watson Rd., 4th Floor, St. Louis, MO 63126

www.gjgrewe.com



GREWE
BROKERAGE &
DEVELOPMENT, LLC

[MID RIVERS PLAZA]

St. Peters, Missouri

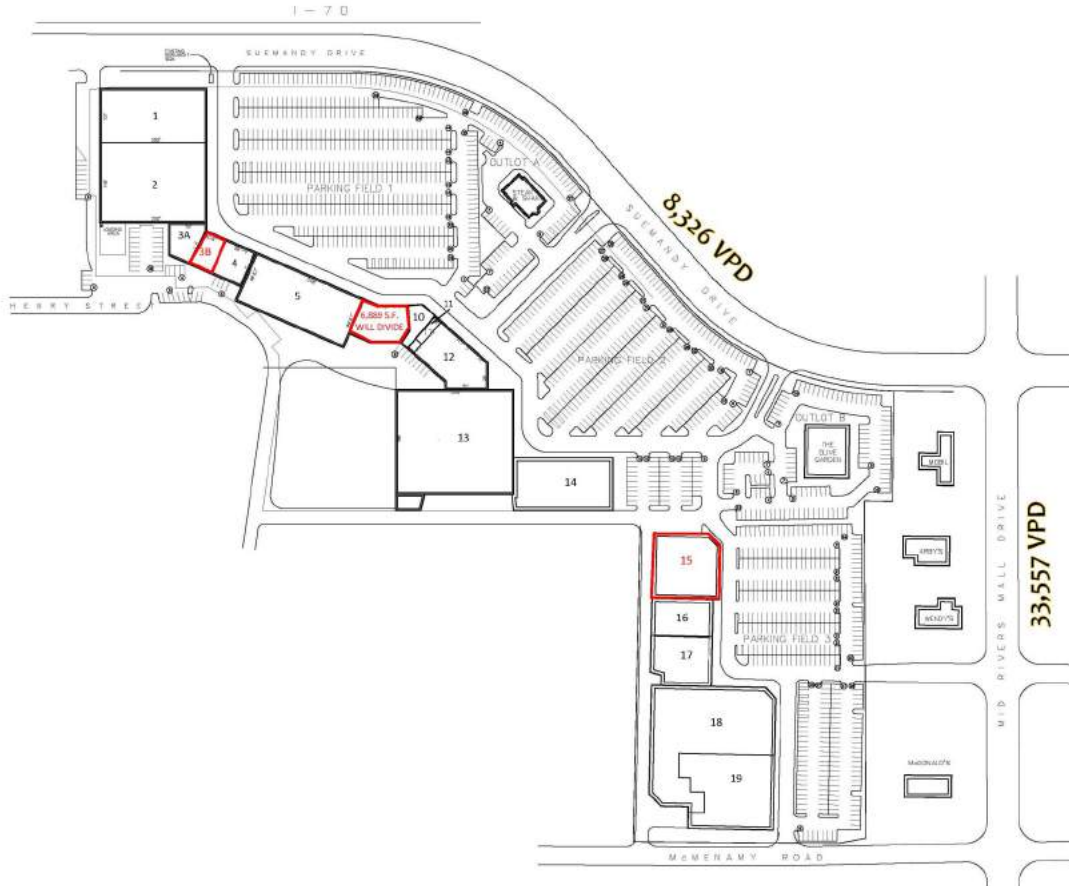

RETAIL SPACE

| | | |
|------|-----------------------------|-------------|
| 1. | Tile Shop | 20,200 S.F. |
| 2. | Big Lots | 29,800 S.F. |
| 3A | Call Center | 4,199 S.F. |
| 3B | Available | 2,869 S.F. |
| 4. | Dentures & Dental Services | 4,185 S.F. |
| 5. | Chuck's Boots | 21,590 S.F. |
| 6-9. | Available (Will Divide) | 6,889 S.F. |
| 10. | Painting With A Twist | 2,311 S.F. |
| 11. | Diverse Cuts | 864 S.F. |
| 12. | Total Hockey Superstore | 10,277 S.F. |
| 13. | Toys "R" Us | 44,620 S.F. |
| 14. | Johnny Mac's Sporting Goods | 18,248 S.F. |
| 15. | Available | 15,000 S.F. |
| 16. | DXL | 8,000 S.F. |
| 17. | Rally House | 9,968 S.F. |
| 18. | Bed Bath & Beyond | 38,843 S.F. |
| 19. | Party City | 15,795 S.F. |

OUTLOTS

- A Steak 'N Shale
- B Olive Garden

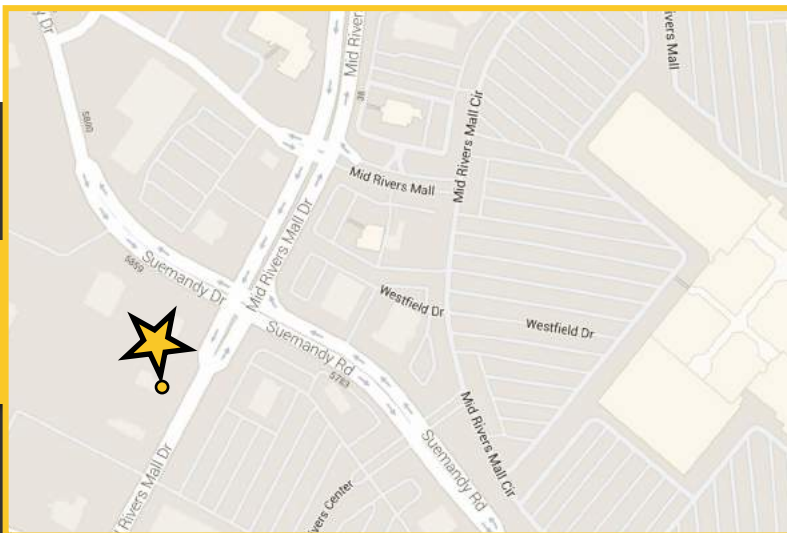

Contact Information:
Gary Grewe
314.962.6300
gary@gjgrewe.com

GOOD NEWS FOR PEOPLE ON THE GROW.

G.J. Grewe Brokerage & Development LLC 9109 Watson Rd., 4th Floor, St. Louis, MO 63126

www.gjgrewe.com