



GREWE
BROKERAGE &
DEVELOPMENT, LLC

9109 WATSON

St. Louis, Missouri

OFFICE SUITES & RETAIL SPACE



Contact Information:
Kyle Lenzen
 314-600-2351—klenzen@gjgrewe.com
Angelina Hristova
 314-800-4549—angelina@gjgrewe.com

EXECUTIVE OFFICE SUITES & RETAIL

Looking for a professional office environment with access to cutting edge technology without the cost and frustration associated with opening your own business? G.J. Grewe Office Suites is pleased to offer suites ranging from 107 SF to 3,900 SF. With convenient access to I-44 and I-270, our office suites are the perfect solution for small businesses. The 3,900 square foot availability has an exterior entrance and storefront along with pole signage availability that would accommodate any retail user.



Current tenants include:



Located On Watson Rd. St. Louis, MO

[DEMOGRAPHICS]

	1-Mile Radius	3-Mile Radius	5-Mile Radius
Med. Household Income	\$67,887	\$68,555	\$65,231
Total Population	10,476	91,771	234,854
Daytime Employment	3,824	48,485	143,207

[AVERAGE DAILY TRAFFIC]

Watson Rd.	17,745 VPD
------------	------------



GOOD NEWS FOR PEOPLE ON THE GROW.

G.J. Grewe Brokerage & Development LLC 9109 Watson Rd., 4th Floor, St. Louis, MO 63126
www.gjgrewe.com



GREWE
BROKERAGE &
DEVELOPMENT, LLC

9109 WATSON

St. Louis, Missouri

OFFICE SUITES & RETAIL SPACE

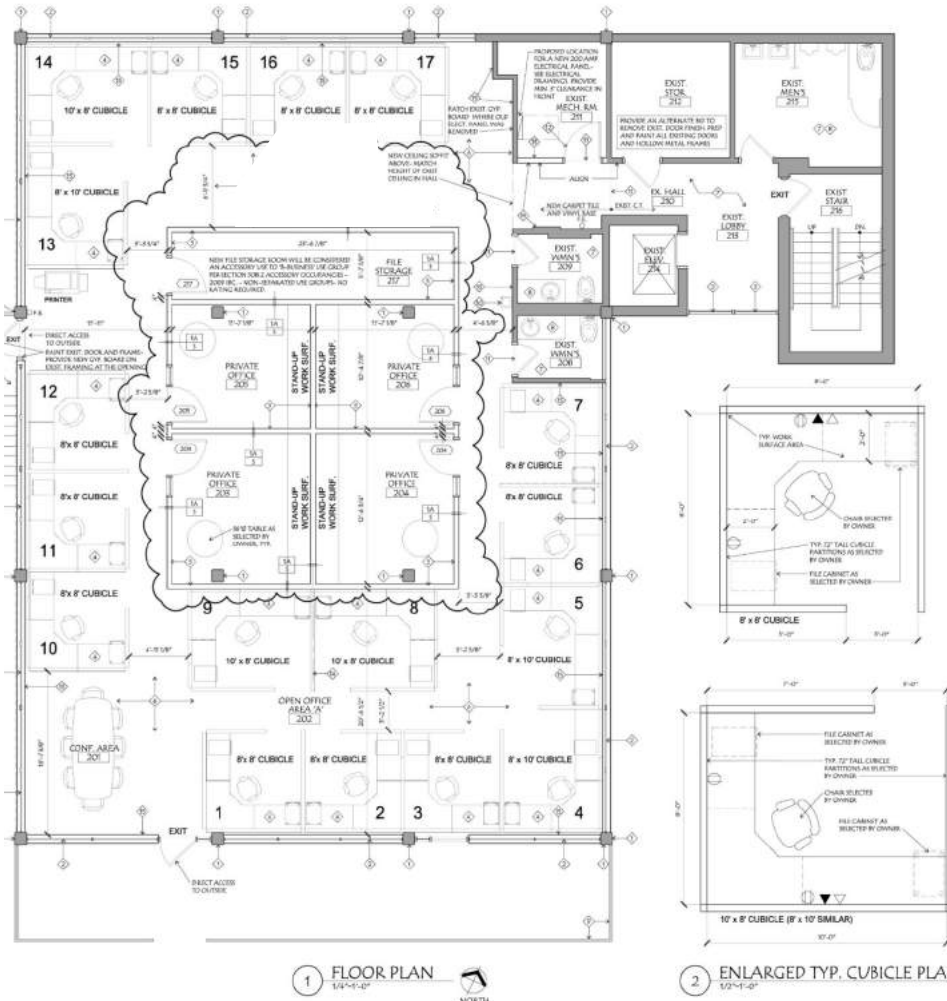

3,900 sf
Office or Retail Use



Contact Information:

Kyle Lenzen	Angelina Hristova
314-600-2351	314-800-4549
klenzen@gjgrewe.com	Angelina@gjgrewe.com

GOOD NEWS FOR PEOPLE ON THE GROW.

G.J. Grewe Brokerage & Development LLC 9109 Watson Rd., 4th Floor, St. Louis, MO 63126

www.gjgrewe.com